

# MARSH MADNESS

## SANDHILL CRANE FESTIVAL

PRESENTED BY  
*FRIENDS OF GOOSE POND*

IN PARTNERSHIP WITH  
INDIANA DNR



FRIDAY & SATURDAY,  
FEBRUARY 20 & 21, 2026



Scan for digital guide



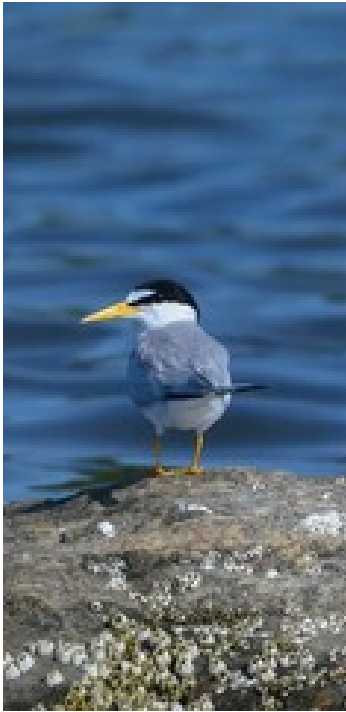

Friends of Goose Pond is proud to present the 17th annual Marsh Madness Festival celebrating the spring migration of sandhill cranes, whooping cranes, and numerous waterfowl to the Goose Pond Fish and Wildlife Area, a 9000-acre wetland complex south of Linton, Indiana. Marsh Madness features a variety of cultural, educational, and wildlife conservation-oriented experiences. There's something for everyone: migrating cranes and waterfowl, wetland driving tours, educational exhibits at the Goose Pond Visitors Center, wildlife art display, and family and kids' nature activities at the Roy Clark building in the Linton city park. A festival such as this doesn't happen without the support of the community. The planning committee wishes to thank the following for their support.

## GOLD PATRON



**CORTEVA**<sup>TM</sup>  
agriscience

Worthington Production Plant  
812-875-2400



## WHOOPING CRANE PATRON



# SANDHILL CRANE PATRON

## The Seketa Family



## GREAT BLUE HERON PATRON

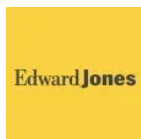

Olivia Kendall  
Wyndham



David Rupp



Walton Funeral  
Services, IN



## IN-KIND SPONSORS

City of Linton

Linton Stockton Chamber of Commerce

Brian Woods Auctioneer

Linton Elks # 866

Bruce Neckar in house artist





# Schedule of Events

## Friday, February 20, 2026

---

**KICK-OFF EVENT LINTON ELKS CLUB -  
LINTON, IN**

Doors open at 5pm - Full Buffet Dinner at 6pm  
Silent Auction and Live Auctions  
Tickets \$30 and include Saturday events

## Saturday, February 21, 2026

---

**HUMPHREYS PARK: 8AM-4PM**

**TICKETS ARE \$5 AT THE DOOR**

- Day-of tips where bird guides are posted.
- Two Scavenger hunts with prizes, 1 in the Roy Clark Building and 1 at the Visitors Center
- Birds of Prey: 10 am and 2 pm Roy Clark Building
- Owl Pellet Activity for Kids and Adults, Amy Kearns, 11am Girl Scout Cabin
- Bee Keeping, Randall Burcham, Greene County Beekeepers, 12pm Girl Scout Cabin
- Resolving one of Indiana's Most Elusive Amphibians, Nate Engbrecht, 1pm Girl Scout Cabin
- Hoosier Herpetological Society "live reptiles and amphibians on display" all day, Roy Clark Building
- International Crane Foundation information table, Roy Clark Building
- Hands-on wildlife learning table, Roy Clark Building
- Marsh Madness cool merchandise available, Roy Clark Building
- Breakfast and lunch (8:00am - 4:00pm) Wilkes Concessions; Roy Clark Building
- Bat Houses to make, West Shelter House
- Bird Feeder Workshop: Terry Wise; West Shelter House
- Guided wetland bus tours begin at 8:30 am last bus leaves at 3:00 pm, East Shelter House
- Arts and Craft Vendors 9:00 am to 4:00 pm Roy Clark Building, Linton Park
- East Shelter House-Bus Stop
- Cheryl Goodman; Coloring for kids, 9:00am to 4:00 pm, East Shelter House



# Saturday, February 15, 2025

---

## GOOSE POND FISH AND WILDLIFE AREA VISITORS CENTER

- Master tracker program
  - Visitors Center Exhibits
  - Intl Whooping Crane Foundation -Crane-themed Crafts and Activity Pages
  - Get your picture taken with Hope the Whooping Crane 9:00 to 9:30am and 12:30 to 1 pm
  - Nature trail walking tours
  - Whooping Crane foundation outreach table
  - Inside spotting scopes
  - Bus stops on guided wetland tour-3 buses with guides
- 

## WILDLIFE ART EXHIBITION

### FEATURED ARTIST BRUCE NECKAR



#### B R U C E N E C K A R

Bruce Neckar, an American fine artist was born and raised in Noblesville, Indiana. Neckar was an Honors Graduate, and earned his B.A. from Ball State University in 1971. While at Ball State, Neckar was a Graduate Teaching Assistant to Thomas Minkler. Minkler was a well-known artist and printmaker, and served as the Chair of the Art Department and a Master Printer. Minkler served as an inspiration and mentor to Neckar.

Neckar is the recipient of multiple local and national awards, including Best Publication National Design Award from the Kansas Graphic Guild; Special Contribution to Graphic Design, Indiana Society of Architects; Evansville Regional Fine Arts Best of Show; Central States Regional Premium Award, Best Drawing Category; Swope Gallery, National Exhibition, Terre Haute, Indiana, and many more. He also has had several pieces of work purchased for private and museum collections, internationally and has been involved in numerous group, and one-man exhibitions.

For many years, he was the Creative Director, Art Director, and Senior Designer for a large Mid-western print firm. Neckar has also developed and assisted in workshops and lectures. He opened the Neckar Gallery in 1980, located in his hometown, Noblesville, Indiana.

Edward Hopper, Winslow Homer, and Jasper Johns are artists that Neckar sights as influences, but his greatest influence is nature itself, and is most often the subject of his work—though he does not consider himself to be a “nature artist.” Neckar has a strong affinity for nature conservancy, and belongs to many nature-oriented organizations. Active in local and national environmental issues, Neckar also serves as the Artist in Residence for Casting For Recovery Indiana, a not-for-profit organization devoted to the physical therapy and support of breast cancer survivors.

A lifelong musician, Neckar is also a founding member of the Poison River Boys, a bluegrass group that has performed all over central Indiana. He lives in Noblesville, Indiana, with his wife, Karen, also an artist, along with his dogs.

Bruce Neckar  
317-379-1275

## MARSH M A D N E S S



# Vendor List

---

- Stone Branch Images - Photography, Carol Kiser
- Dwight R. Chamberlain Raptor Center-birds of prey
- Hoosier Herpetological Society "live reptiles and amphibians on display"
- Beck's Homemade-Goat Milk Soap, Candles, Body Butter, Bird Houses/feeders and more
- Laura LaRoche-Crochet items, wool needle felting, mini gourds and pictures
- Sue Westhus-Homemade gourds
- International Crane Foundation
- Friends of Goose Pond-T-shirts, hats and much more
- Wabash Valley Audubon's Society
- George Sly-Skins, Skulls and Feathers
- Blue Aster Studio-magnets, stickers, nature inspired art, tote bags, buttons
- Dancing Bear Farms-honey, beeswax candles, tote bags recycled and from feed bags, yarn from sheep
- Greene County Master Gardners-plants and garden tools
- Tulip Woods-herb starts-micro tomato plants, botanically inspired handmade greeting cards
- New Hope Lavender specializes in the growing lavender and creating and selling lavender products
- Home, Heart and Art-Jenni Robbins
- Tom Clayton-Veterans Table
- Watershed Alliance-Laura Demarest
- Greene County Soil and Water-Invasive Species
- Hickory Tree Studio-Walt Schmidt



# Event Map

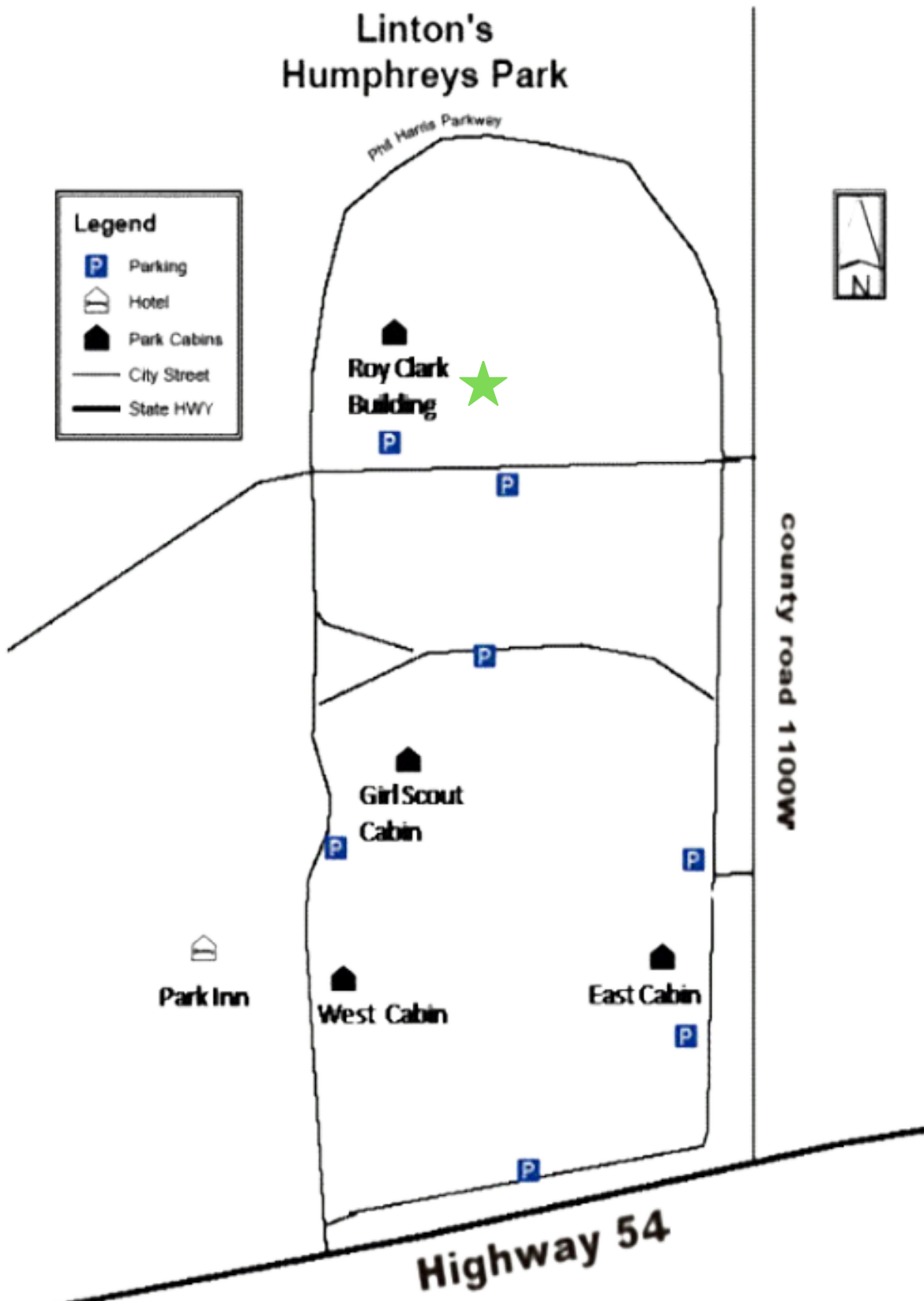

# Seasonal Bird list

---

## DUCKS, GEESE & SWANS

- Greater white-footed goose
- Snow goose
- Canada goose
- Trumpeter swan
- Tundra swan
- Gadwall
- Mallard
- Norther shoveler
- Northern pintail
- Canvasback
- Redhead
- Hooded merganser

## UPLAND GAME BIRDS

- Wild turkey
- Northern bobwhite

## GREBES

- Pied-billed grebe

## HERONS

- Great-blue heron

## RAPTORS

- Bald eagle
- Red-tailed hawk
- Northern harrier
- American kestrel

## CRANES

- Sandhill crane
- Whooping crane

## GULLS

- Ring-billed gull

## PIGEONS & DOVES

- Rock pigeon
- Mourning dove

## MIMIC THRUSHES

- Northern mocking bird

## OWLS

- Barred owl
- Short-eared owl

## NEW WORLD SPARROWS

- White-throated sparrow
- Song sparrow
- White-crowned sparrow
- American tree sparrow
- Eastern towhee

## KINGFISHERS

- Belted kingfisher

## CARDINALS

- Northern cardinal

## WOODPECKERS

- Red-bellied woodpecker
- Northern flicker
- Downy woodpecker
- Pileated woodpecker

## BOBOLINKS & ORIOLES

- Red-winged blackbird
- Eastern meadowlark
- Common grackle

## FINCHES

- American goldfinch
- House sparrow

## CROWS & JAYS

- Blue jay
- American crow

## CHICKADEES AND TITMICE

- Carolina Chickadee
- Tufted Titmouse

## THRUSHES

- Eastern bluebird
- American robin

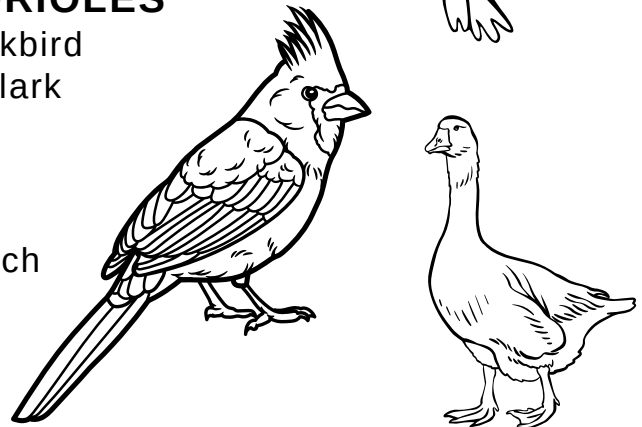
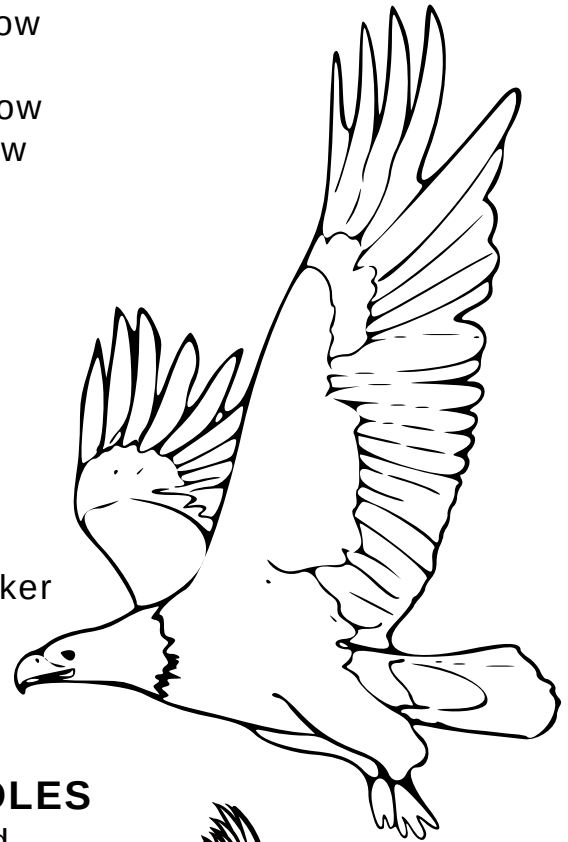

# Self-driving Tour Directions

---

## **Be safe. Be aware of the other vehicles around you.**

1. Do not stop in the middle of the road. Leave room for other vehicles to pass.
2. DO NOT pull off the side of HWY 59 unless it is into a marked parking area.
3. Be respectful of private property. This driving tour passes through both public and private ground. Do not go onto private property without permission.
4. If you stop to watch some cranes in fields, it is strongly recommended that everyone remain in their vehicle. Not only is this more safe, but the cranes are much less likely to become nervous and leave the field.
5. Be as quiet as possible. No horn honking, engine revving etc..
6. This driving tour is on State, County and City roads. All applicable traffic laws apply.
7. The majority of this tour is on gravel roads. You may encounter rough spots in the road. Your vehicle will get dirty.

From the NW corner of Humphreys Park:

Take E Street NE west approximately .7 miles to 4th Street NE

Take 4th Street NE south approximately .25 miles to HWY 54

Take HWY 54 west approximately .25 miles to HWY 59

Take HWY 59 south approximately 1 mile to county road 25S

Take county road 25S west approximately 2 miles to county road 1400W

Take county road 1400W south approximately 1.75 miles to county road 200S

Take county road 200S west approximately .6 miles to county road 1450W

Take county road 1450W south approximately 1.9 miles to county road 400S

**Be sure to stop and check out the new Visitor Center. The office will be staffed throughout the day to answer questions.**

Take county road 400S east approximately 1.5 miles to HWY 59

Take HWY 59 north approximately 3.0 miles to county road 200S

Take county road 200S east approximately 2.0 miles to county road 1000W

Take county road 1000W north approximately 1 mile to county road 100S

Take county road 100S west approximately .25 miles

Take county road 1050W north approximately 1.0 miles to Baseline Road

Take Baseline Rd. east approximately 1 mile to county road 1000W

Take county road 1000W north approximately 2 miles to SR 54.

Go west to return to Linton/Humphrey's Park.



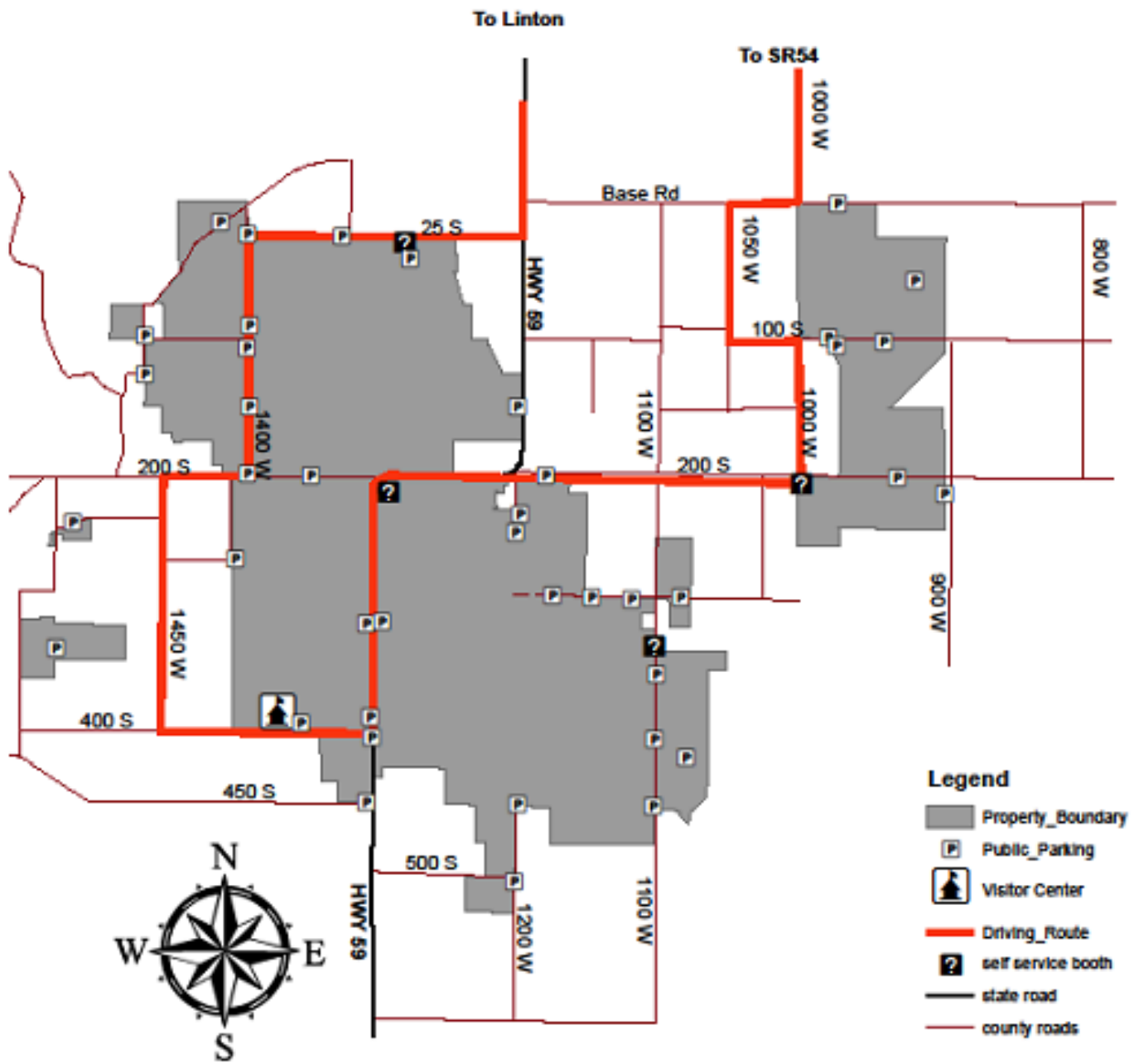

# Bus Tour Schedule

---

All buses arrive and depart from the East Cabin in Humphreys Park.

BUS	DEPARTURE	RETURN
1	8:30	10:00
2	9:00	10:30
3	10:30	12:00
1	11:30	1:00
2	11:00	12:30
3	12:30	2:00
1	2:00	3:30
2	1:30	3:00
3	3:00	4:30

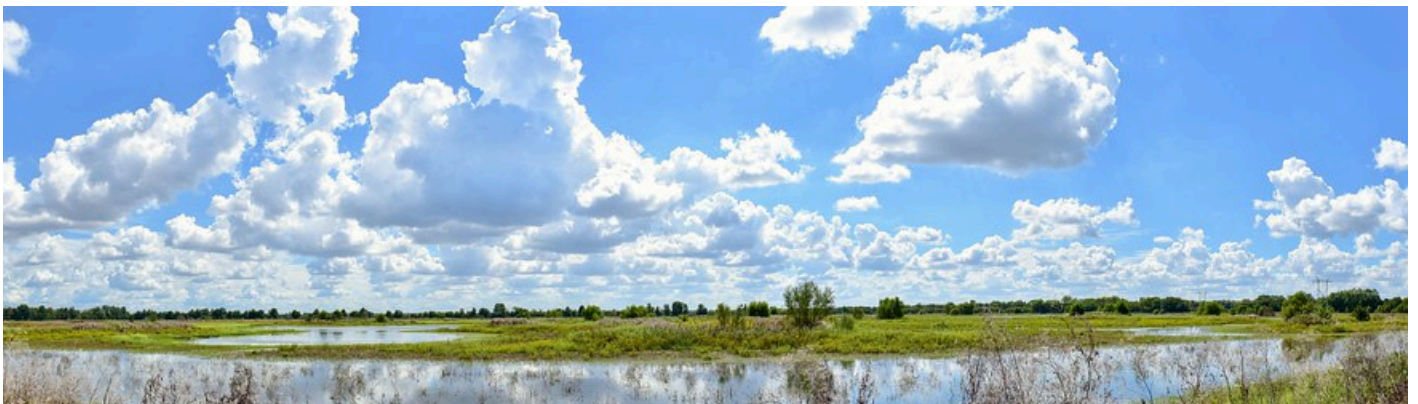



THE PLANNING COMMITTEE THANKS YOU, THE FESTIVAL ATTENDEE, FOR YOUR INTEREST AND SUPPORT. WE HOPE YOU ENJOY THE 2026 MARSH MADNESS SANDHILL CRANE FESTIVAL AND YOUR VISIT TO GREENE COUNTY, INDIANA. WE HOPE TO SEE YOU AGAIN SOON.



OUR VISION - GOOSE POND IS A WILDLY DIVERSE GLOBAL ECOSYSTEM INSPIRING, EDUCATING, AND PROVIDING RECREATION FOR ALL.

OUR MISSION - TO SUPPORT THE GOALS OF WILDLIFE CONSERVATION AND HABITAT RESTORATION AT THE GOOSE POND AND SURROUNDING AREAS THROUGH EDUCATION, RESEARCH, AND RECREATIONAL ACTIVITIES AND PROGRAMS.

THE MISSION OF THE DIVISION OF FISH & WILDLIFE IS TO ENRICH THE QUALITY OF LIFE FOR PRESENT AND FUTURE GENERATIONS BY BALANCING THE BIOLOGICAL, ECOLOGICAL, RECREATIONAL, AND ECONOMIC BENEFITS OF INDIANA'S FISH, WILDLIFE AND THEIR HABITATS.

